

Vogelzang LC-37 Log Cart

Thank you for purchasing Vogelzang International's LC-37 Log Cart. The following instructions show you how to easily assemble your new cart.

Tools Requires: You will only need two tools, a 19mm socket wrench (or adjustable crescent wrench) and a 5/32" hex wrench (supplied).

Assembly:

1. Assemble the base by placing the base support lege (F) on either ends of the axle (M).
2. Place the larger, 1/4" bushings (L) on each end of the axle.
3. Place a wheel (O) on each end followed by the smaller, 1/8" bushing (K) and secure the wheel assemblies by threading a 12mm hex nut (N) on each end of the axle.
4. Position the wooden handle (H) into the back vertical support bars (B). The handle is secured with two 5/8" machine screws (P). Wait to tighten until all parts have been assembled.
5. Place two 1" machine screws (R) in the two holes at the rear of the bottom vertical support bars (B). Align screws through the rear set of holes in the base support legs (F) and thread into the base separation bar (G). Use the shorter 5/8" screws (P) in the remaining holes to secure

6. Assemble the front vertical support bars (D) to the base Legs (F).
7. Position the upper separation bars (A) on the inside of the handle assembly vertical support bars (B) and secure with 5/8" machine screws (P).
8. Secure the center back vertical support bar (C) to the upper separation bar (A) as shown by passing a 5/8" machine screw (P) through the separation bar (A) and threading it into the vertical support bar (C).
9. Place a shim (J) over the center hole of the rear (closest the wheels) base separation bar (G). Position the taller, center back vertical support bar (C) over the rear shim (J) and pass a 1" screw (R) through the center vertical support bar (C), through the shim and thread into the rear separation bar (G).
10. Position the center front vertical support bars (E) as shown and attach by passing a 1" machine screw through the vertical support bar, through the shim (J) and thread into the center hole of the base separation bar (G).
11. Secure the front vertical support bars (D & E) to the front upper separation bar (A) with 5/8" screws (P).
12. Tighten all screws securely.

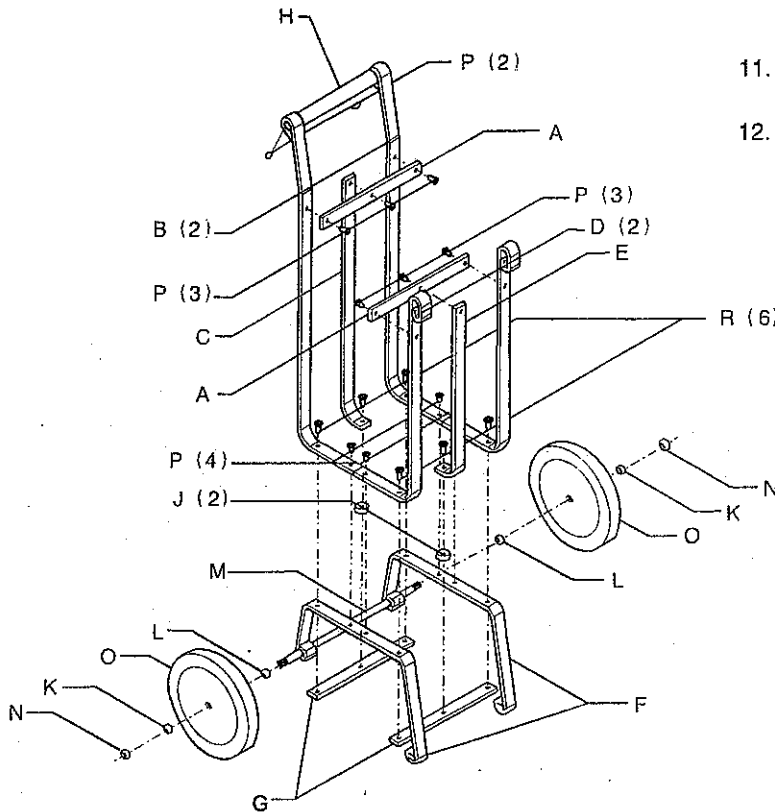

PARTS LIST

Part Ref.	Description	Qty.
A	Upper Separation Bar.....	2
B	Back Vertical Support Bar.....	2
C	Center Back Vertical Support Bar.....	1
D	Front Vertical Support Bar.....	2
E	Center Front Vertical Support Bar.....	1
F	Base Support Legs Bar.....	2
G	Separation Bar.....	2
H	Wood Handle.....	1
J	Round Shim.....	4
K	Bushing, 27/32"OD x 7/16"ID x 1/16".....	2
L	Bushing, 1-3/32"OD x 1/2"ID x 3/32".....	2
M	Axle.....	1
N	Hex Nut, 12mm x 1.75.....	2
O	Rubber Wheel, 10" x 1.25" w/ 1/2" Bearing.....	2
P	Screw, 1/4-20 x 5/8" SKTRHMS.....	12
R	Screw, 1/4-20 x 1" SKTRHMS.....	6

VOGELZANG

International CORPORATION



400 West 17th Street
 Holland, Michigan USA 49423-3440
 Phone: 616-396-1911
 Fax: 616-396-1971
 www.vogelzang.com